

# Town of Fairbanks

T.26 N R.12 E.

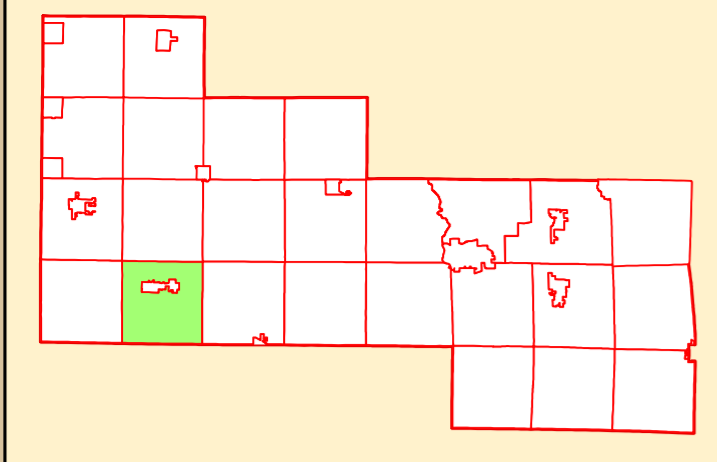

- Federal/State Highways
- County Highways
- Municipal Roads
- Private Roads
- Railroads
- Waterbodies
- Municipalities
- Sections

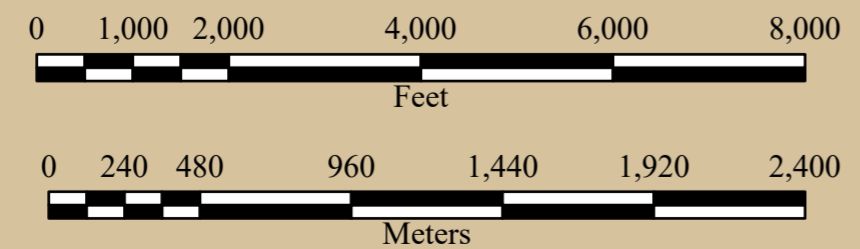
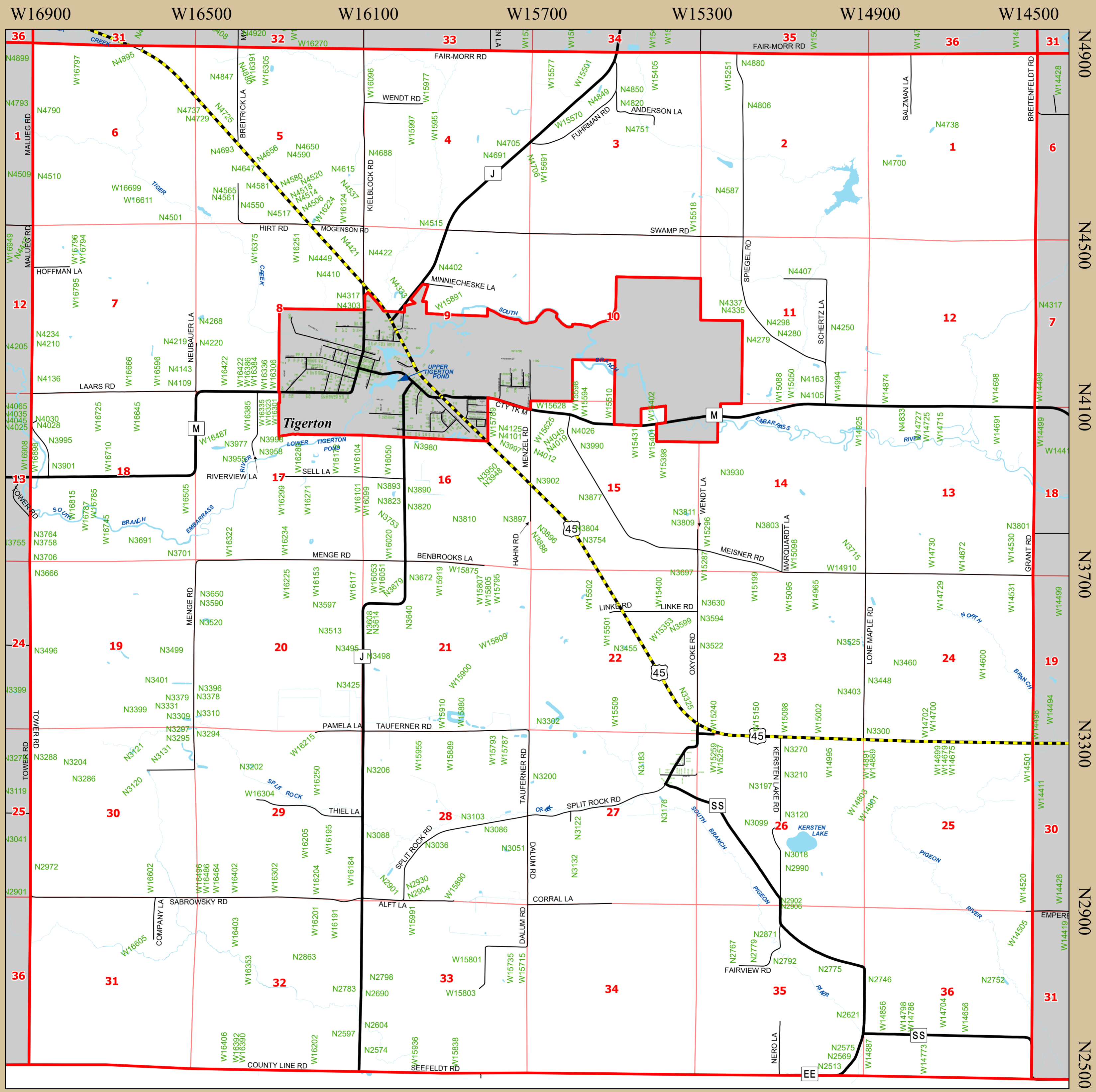

Information depicted on this map was interpreted from digital orthophotography and various other land records. An attempt was made to accurately represent the information shown hereon, however, recent changes in the physical and cultural landscape many not be represented. This map is intended for planning and general use only. Please refer to the original source documents for detailed information. If you have any questions or discover any discrepancies on this map, please contact the Shawano County Technology Services Department: 715-526-4615.

Cartography: Nathan Wehrle  
Shawano County GIS Technician  
Date: 9 August, 2021

